

Assemble the Clutch Unit

www.DraperySewingSupplies.com

Your clutch unit consists of the following pieces:

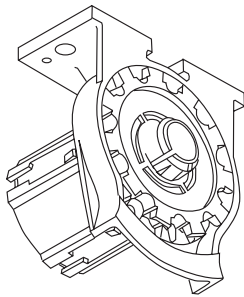

The Unit

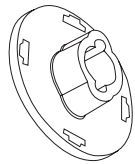

Drive Disk

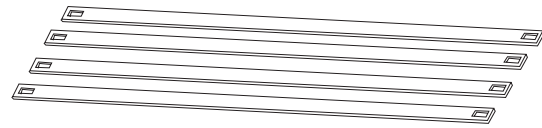

4 Metal Spears

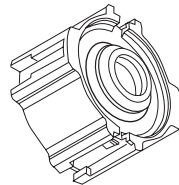

Spear Retainer

PLUS:

(2) 3/4" screws to install the clutch unit to your wood board

(2) 1/4" screws to attach the drive disk to your fiberglass rod

1. Slide the metal spears into the grooves of the unit until they click in place. The locking barbs on the unit will be inside the holes of the spears. You will install all 4 spears into the unit.

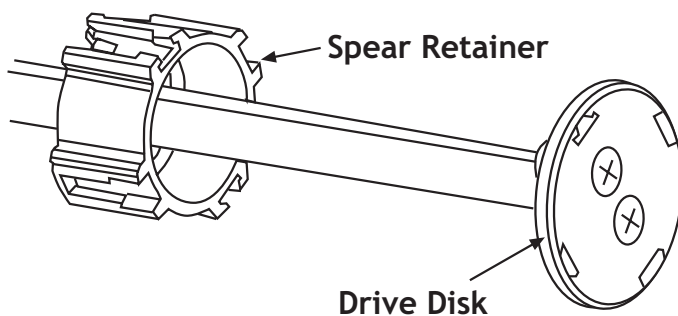
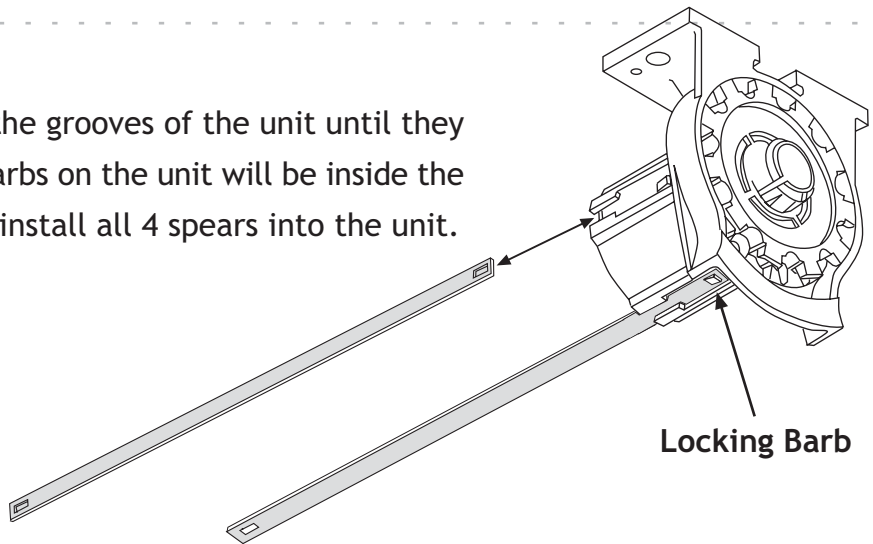

2. Fit one end of the fiberglass rod in the drive disk. This is a very snug fit. Secure this union by screwing the 1/4" screws into the 2 holes of the drive disk.
3. Then slide the spear retainer onto the fiberglass rod. The larger opening should face the drive disk.

Assemble the Clutch Unit (continued)

- Slide each metal spear through a slot on the drive disk. Then slide the spears into the grooves of the spear retainer until they click in place. The locking bars on the spear retainer will be inside the holes of the spears. This process is just like the step where you inserted the metal spears into the clutch unit.

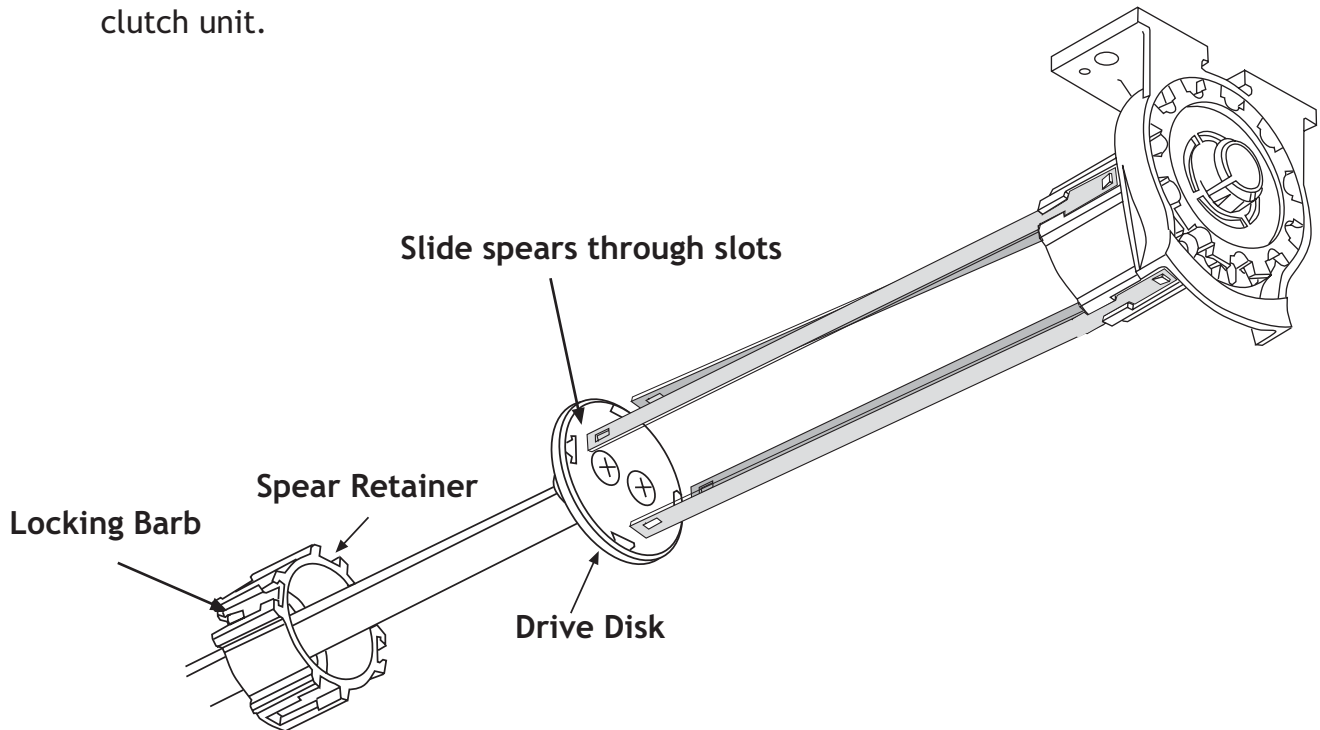

Congratulations!
You've assembled your
clutch unit!

